

DFR-100

Fixed, Bypass-Type, Pressure-Compensated Cartridge Flow Regulator Valve

DESCRIPTION

A fixed bypass-type cartridge valve designed to regulate priority flow while bypassing excess flow regardless of load pressure.

OPERATION

The DFR-100 maintains a constant flow within specified accuracies from ① to ③ regardless of downstream load pressure at ③ or bypass leg ②. When flow produces a minimum predetermined pressure differential across the compensator spool control orifice, the spool shifts against the spring force to throttle the flow and maintain the priority flow setting. Reserve flow is not regulated.

SYMBOLS

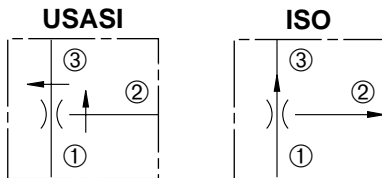

FEATURES and BENEFITS

- Pressure-compensated.
- Quiet response.
- Bypass port ② may be fully pressurized.
- Industry common cavity.
- Compact size.

PRESSURE DROP VS. FLOW

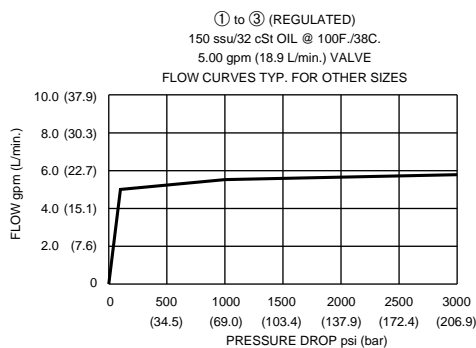

SPECIFICATIONS

Operating Pressure: 3000 PSI (207 Bar). A minimum pressure differential of 100 PSID is required to operate valve.

Flow: Ranges from 1 to 6 GPM (3.8 to 22.7 L/min.)

10 GPM (37.9 L/min.) max. input.

(See ordering table)

Flow Tolerances: Flows up to and including

1.5 GPM (5.7 L/min.) $\pm 15\%$

Flows over 1.5 GPM (5.7 L/min.) $\pm 10\%$

Temperature: -30° F to +250° F (-35°C to +120° C)

Recommended Filtration: ISO 16/12

Fluids: Mineral-based fluids.

For other fluid compatibility consult factory.

Cavity: 100-3, see page 0.21.

Cavity Tool: See page 0.21.

Body Material: Anodized 6061T6 aluminum

alloy rated at 3000 PSI (207 Bar).

INSTALLATION DIMENSIONS

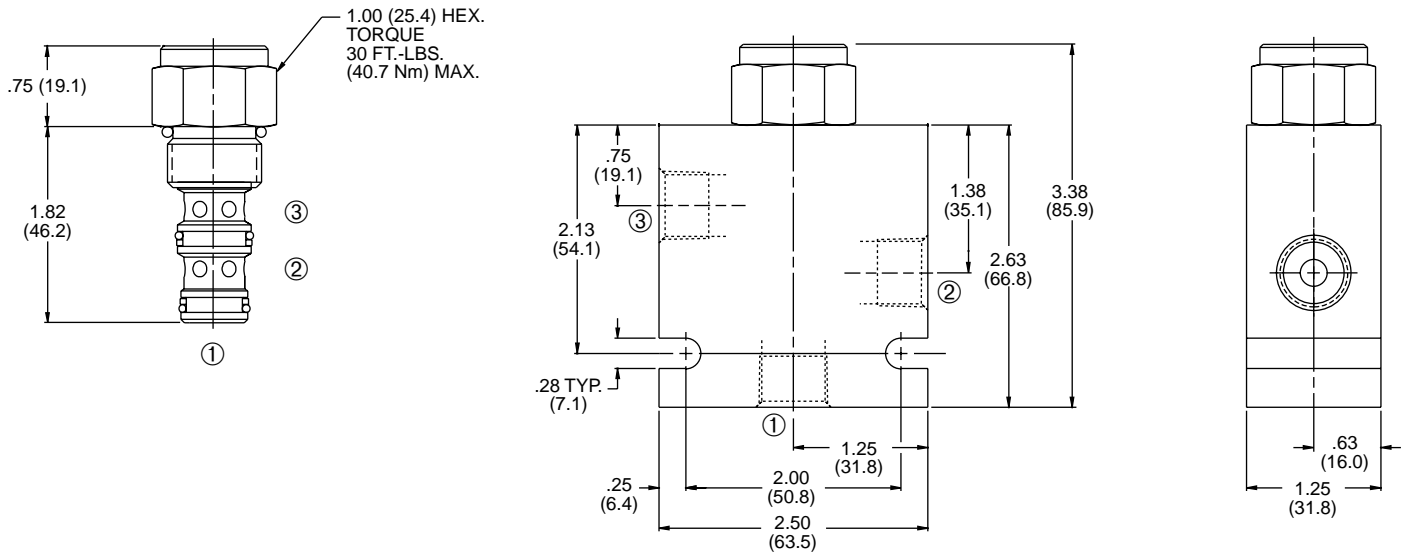

() Parentheses = Millimeters

HOW TO ORDER

