

Pneu-Trol®

PILOT-OPERATED CHECK VALVES

- 4:1 Pressure to Pilot Port Unseats Check Ball, Permitting Free Reverse at Will – 3,000 PSI (207 bar) Operating Pressure
- Permits Normal Free Flow in Direction of Arrow. Positive Ball Check in Reverse Direction
- Three Sizes: 1/4", 3/8" and 1/2"
- Air Pilot Valves Have Secondary Seal on Pilot Piston Stem. A Vent Hole in the Body Between the Piston Seal and Stem Seal Prevents Mixing of Pilot Media and the System Media.

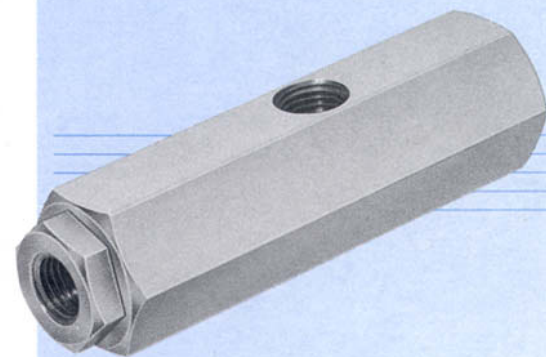

DIMENSIONS

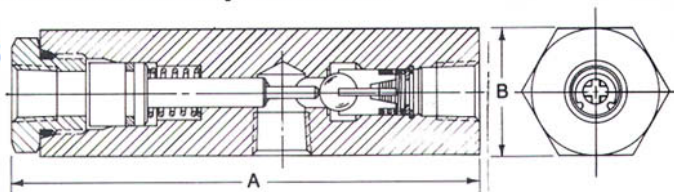

Size	A	B	Pilot Port	Inlet Port	Outlet Port
1/4"	4-1/8" (104.8)	1-1/8" Hex (28.6)	1/4"	1/4"	1/4"
3/8"	4-7/8" (123.9)	1-3/8" Hex (35.0)	1/4"	3/8"	3/8"
1/2"	5-5/8" (142.9)	1-5/8" Hex (41.3)	1/4"	1/2"	1/2"

() Parentheses - Millimeters

ORDERING INFORMATION

NOTE: All Valves:
Ball Check for Hydraulic
Application Only.

Size	*Air Pilot Part Number	**Hydraulic Pilot Part Number	Max. Flow GPM (L/min)
1/4"	—	PIC-20S	6.0 (22.8)
3/8"	—	PIDC-25S	10.0 (37.9)
1/2"	APIDC-30S	PIDC-30S	12.0 (45.5)

* 2.1 Pilot Ratio

** 2.1 Pilot Ratio for Pressures Under 90 PSI.

ISO 7/1 - RS*

Size	Part Number	Max. Flow GPM (L/min)
1/4"	—	6.0 (22.8)
3/8"	—	10.0 (37.9)

* Agrees with BS21:1995.

SPECIFICATIONS

Maximum Operating Pressure
3,000 PSI (207 Bar)

Operating Temperature Range (O-Ring)

Buna N: -40° to +212°F (-40° to +100°C)

Materials

All Steel Construction