

DRNV-100

Rotary,
Flow Control

SERIES 10

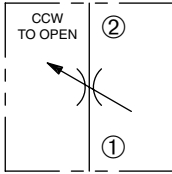

DESCRIPTION

A cartridge valve designed to provide variable flow restriction in both directions.

OPERATION

The DRNV-100 varies flow restriction by adjusting spool open or closed. Flow is metered from ① to ② and ② to ①.

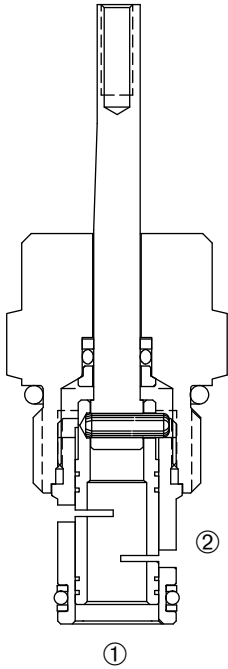

FEATURES and BENEFITS

- Hardened spool and sleeve for long life.
- Industry common cavity.
- Compact size.

SPECIFICATIONS

Operating Pressure: 3000 PSI (207 Bar)

Max. Flow: 6 gpm (23 l/min)
9 gpm (34 l/min)
12 gpm (45 l/min)

Internal Leakage: 82 cc/min at 3000 PSI (207 Bar)

Temperature: -30°F to +250°F (-35°C to +120°C).

Recommended Filtration: ISO 17/15/13

Fluids: Mineral-based fluids.

Cavity/Cavity Tool: 100-2, see page 11.10.2

In-Line Body Material: Anodized 6061T6 aluminum alloy rated at 3000 PSI (207 Bar).

PRESSURE DROP VS. FLOW

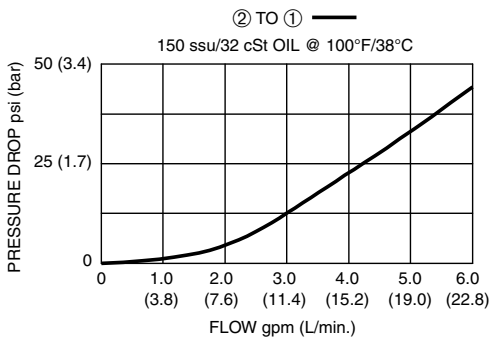

INSTALLATION DIMENSIONS

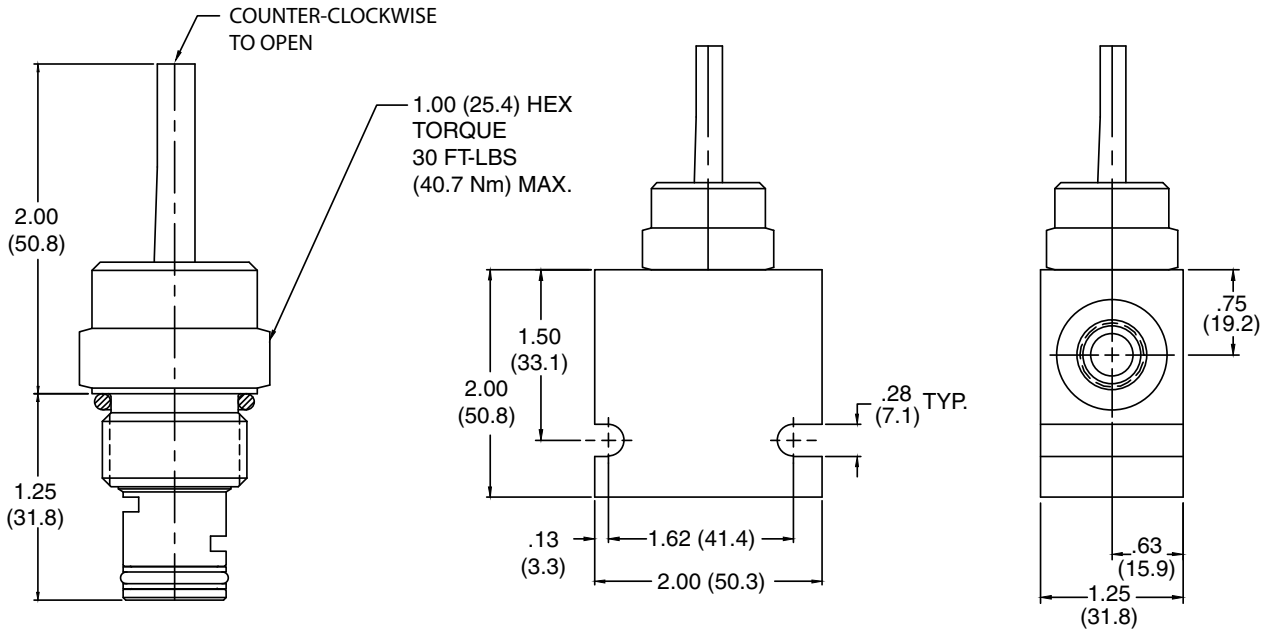

() Parentheses = Millimeters

HOW TO ORDER

